

Adobe Creative Cloud; Work at Home

1. Navigate to www.adobe.com
Enter your Montserrat email address and select "Enterprise ID" when prompted. You will use your Montserrat Network Password to login to Adobe.

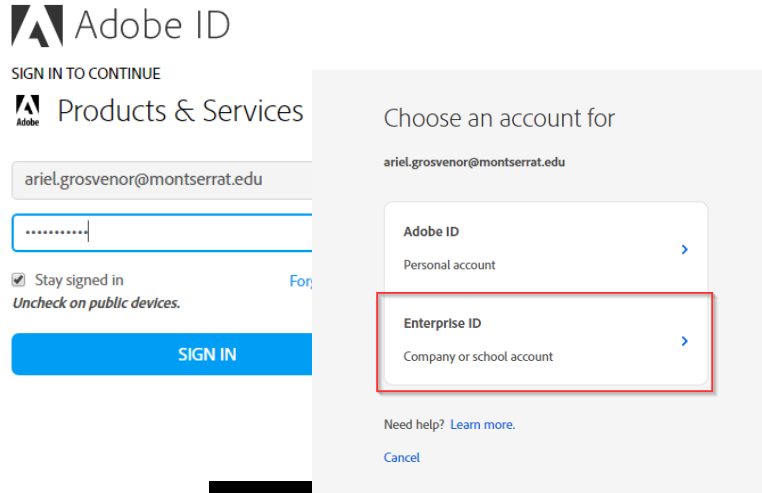

2. Once signed in, select "Desktop Downloads" under Creative Cloud Apps and you will find the CC Desktop App towards the bottom of the page, labeled "Creative Cloud".

Download & install the CC Desktop app

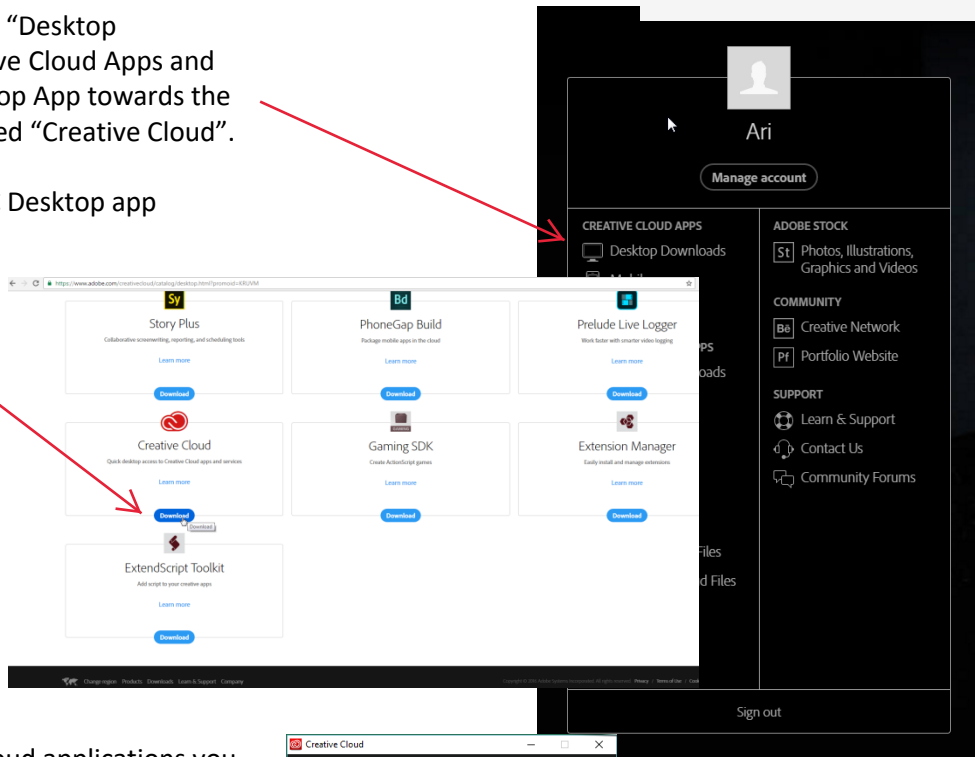

3. Install the Creative Cloud applications you wish to use from within the Desktop app.

If you already have the CC Desktop app, sign in with your Montserrat Adobe ID and your products will license.

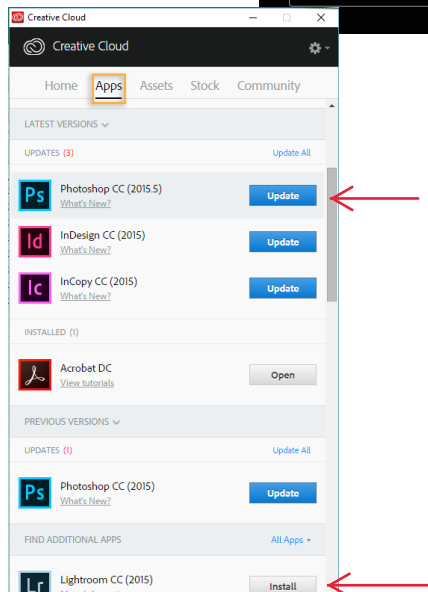

NOTE: Creative Cloud Desktop app is the easiest way to manage your installed applications, though if you prefer you are able to download them individually from the website (the Desktop App provides a central location to manage updates, additional installs and your account)